

Manual radiator valves Art.238 – 239 – 240 – 241 - 242



100% MADE IN ITALY 

Function

Pintossi + C manual radiator valves are shut-off devices used on radiators for controlling and regulating the fluid flow exclusively by manual action.

They are available in angle or straight version for the connection with iron pipe, copper pipe, PEX or multilayer pipes.

The sealing between the valve and the radiator is guaranteed by **PTM system** (Pintossi soft sealing), which allow a quick and safe installation, without the use of additional sealing materials, like hemp or PTFE ribbon.

They are featured by a quiet functioning, these valves can be installed in every two pipes heating systems, with vertical or horizontal distribution.

Products range

Art. 238	3/8" – 1/2" – 3/4"	Angle valve with iron pipe
Art. 239	3/8" – 1/2" – 3/4"	Straight valve for iron pipe
Art. 240	3/8" – 1/2"	Angle valve for copper, plastic and multilayer pipe
Art. 241	3/8" – 1/2"	Straight valve for copper, plastic and multilayer pipe
Art.242	1/2"	Angle valve for copper, plastic and multilayer pipe with pre-setting

Technical specifications

Fluids:	Water or glycol solutions
Max. glycole:	30%
Max. working temp.:	100°C
Max. working pressure:	10 bar

Materials

Body:	Brass CW617N
Stem:	Brass CW617N
Screw:	Brass CW617N
Tail and nut:	Brass CW617N
Gaskets:	NBR
handwheel:	ABS



Dimensions

Angle manual radiator valves										
ART.	A	B	C	D	E	F	G	H	I	J
238	21	25	35	57	21,5	78,5	3/8"	8	3/8"	50
	25,5	30	35	57,5	24	81,5	1/2"	10	1/2"	52,5
	31,5	37	38	57	26,5	83,5	3/4"	11	3/4"	63,5
240		25	35	58	21,5	79,5	24x19	8	3/8"	50
242		30	35	57,5	22,5	80	24x19	10	1/2"	52,5

Straight manual radiator valves									
ART.	A	B	C	D	E	F	G	H	I
239	3/8"	3/8"	23	48	71	65,5	35	21	25
	1/2"	1/2"	25	49	74	65,5	35	25,5	30
	3/4"	3/4"	28	60,5	82,5	87,8	35	32	37
241	24x19	3/8"	24	47,5	71,5	65,5	35	21	25
	24x19	1/2"	24	49,5	73,5	65,5	35	25,5	30

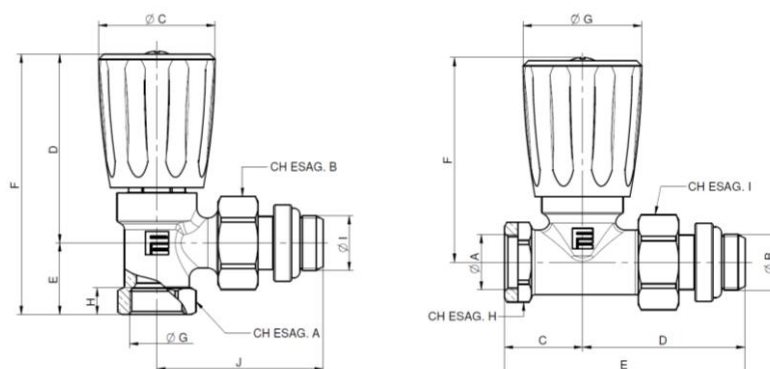

Head loss diagrams

On the below diagrams are shown the head loss diagrams

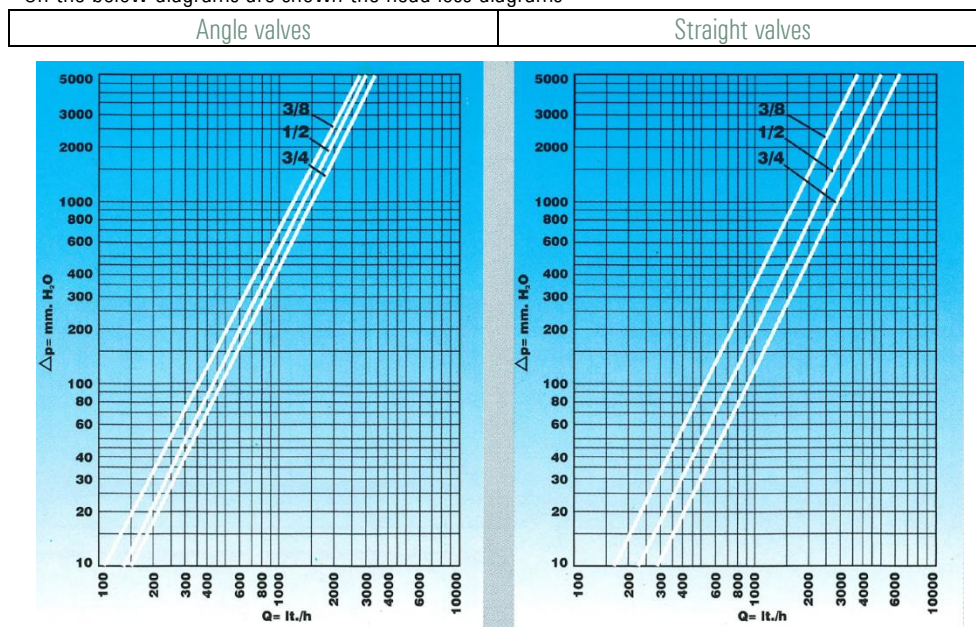

pintossi+c

Fluid characteristics

Reference standard for water treatments in heating systems is Norm UNI 8065:2019 which regulates the parameters that must be observed to avoid scale and corrosion phenomena.

In order to grant product warranty, the fluids characteristics must comply with the rules in force in the country of relevance or at least present features not less to the ones prescribed by the Norm UNI 8065:2019.

In particular, minimum standards necessary but not sufficient to control are the following:

Fluid aspect:	Limpid
PH:	Between 7 and 8
Iron (FE):	< 0,5 mg/kg (< 0,1 mg/kg for steam)
Copper (CU):	< 0,1 mg/kg (< 0,05 mg/kg for steam)
Antifreeze:	Passivated Propylene Glycol
Conditioning:	as indicated by the producer

In any case when using antifreeze and conditioning solutions, is required to control and verify the correct compatibility between these substances and the construction materials stated in Pintossi + C technical datasheet.

